

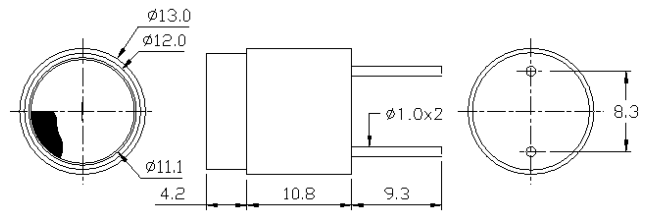

Dimensions: dimensions are in mm



Impedance/Phase Angle vs. Frequency

Tested under 1Vrms Oscillation Level

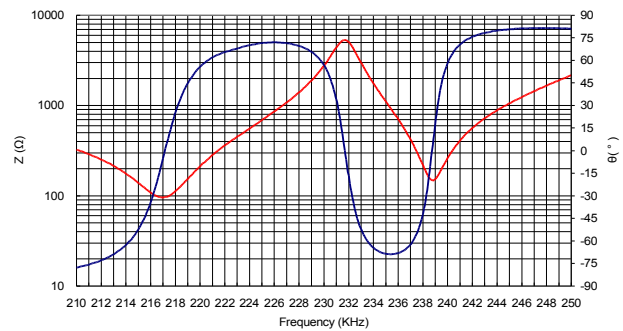

Specification

235SR130	Transceiver
Center Frequency (KHz)	235.0±10.0
Overall Echo Sensitivity 0dB = 20Vp-p @ 25 cm	-61 dB min. (40 bursts)
Bandwidth (Echo Sensitivity)	10KHz
Capacitance at 1KHz ±20%	540 pF
Max. Driving Voltage (Pulse)	80Vpp 10% duty cycle tone burst
Total Beam Angle	-3dB 7.0° typical
	-6dB 10.0° typical
Matching Window	Silicone Rubber
Operation Temperature	-20 to 60°C
Storage Temperature	-30 to 70°C

All specification taken typical at 25°C
Closer frequency tolerance, shorter ringing and wider bandwidth models can be supplied upon request.

Model available:

1	235SR013	Aluminum Housing
---	----------	------------------

Echo Sensitivity

Tested under 20Vp-p @25cm; 0dB=20Vp-p

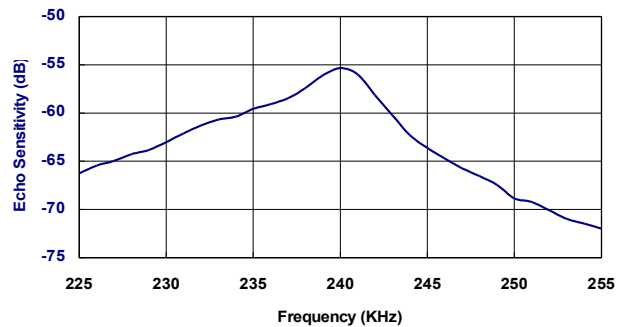

Beam Angle: Tested at 235.0KHz frequency

Reflector: Aluminum Plate L75×W75×T10 (mm)

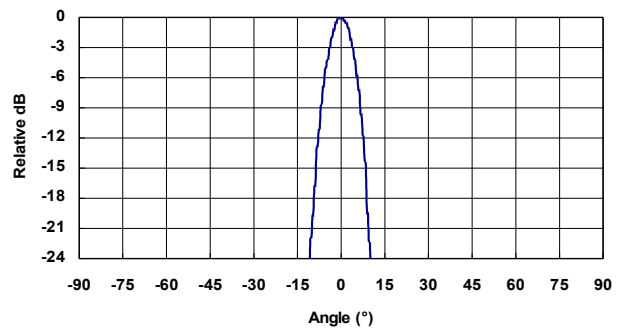

S. Square Enterprise Company Limited
Pro-Wave Electronics Corporation

[Http://www.pro-wave.com.tw](http://www.pro-wave.com.tw) ; E-mail: sales@pro-wave.com.tw ; Tel: 886-2-22465101 ; Fax: 886-2-22465105