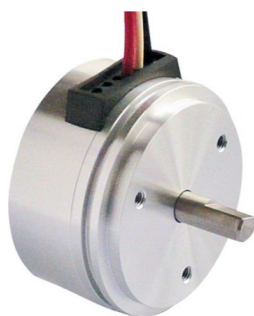
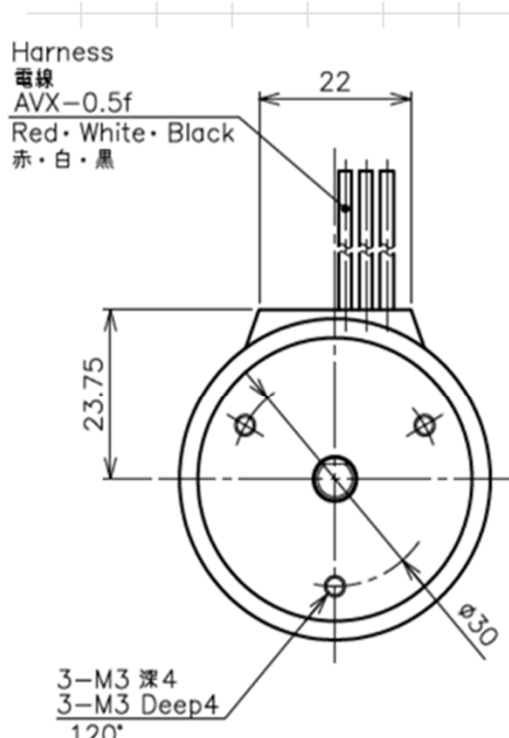
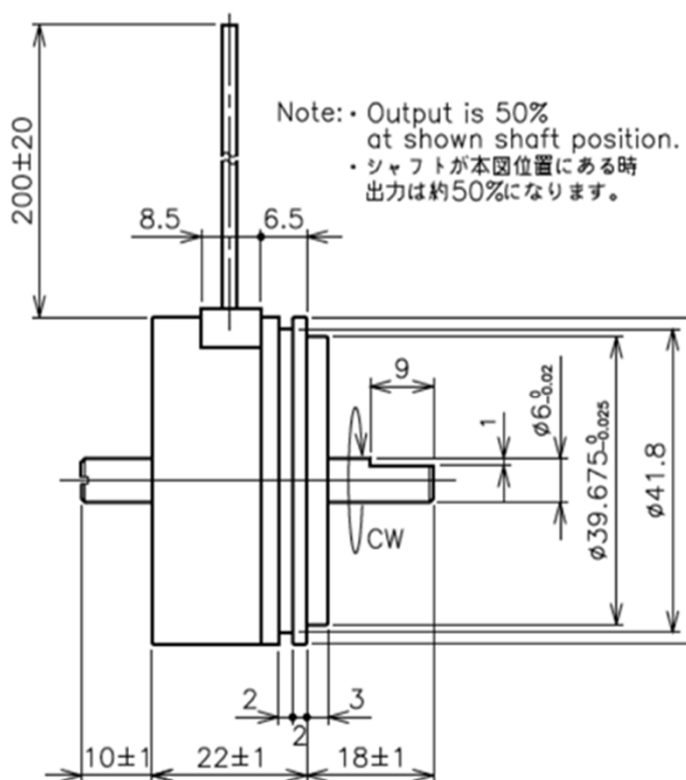
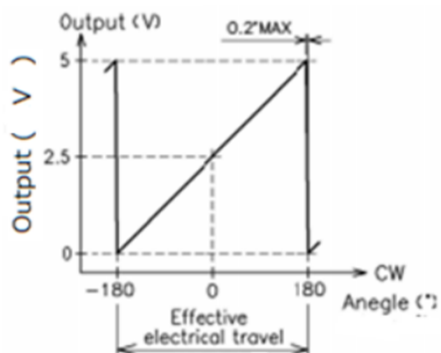
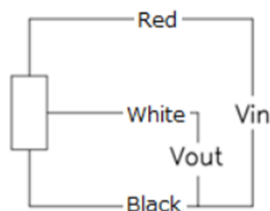

Contactless Hall-IC Angle Sensor

CP-45H Series - CP-45Hx-5V

- Contactless Hall-IC Angle Sensor
 - Effective Electrical Travel : $\pm 180^\circ$
 - Absolute Linearity : $\pm 1\%$ FS
 - Input Voltage : DC8~32V
 - Output Range : DC0~5V
 - IP Rating : IP54
 - Output : Dual Output(6 wires, 4 wires)
- [Option]**
- Effective Electrical Travel : $\pm 45^\circ \sim \pm 180^\circ$
 - Inverse output is available by programming.

Dimension [mm]**Output Characteristics****Schematic**

• Red, White, Black: Harness Colors

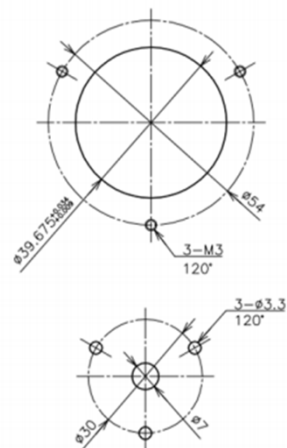
Mounting

■ Dimension [mm]

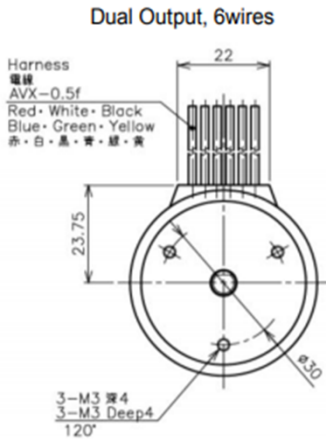

■ Schematic

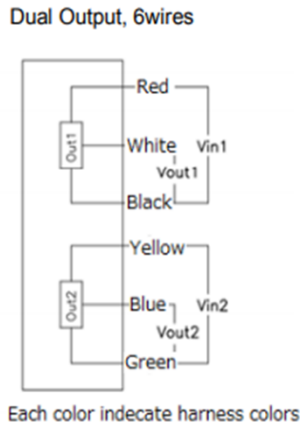

■ Mounting

CP-45HC-5V Cross Output

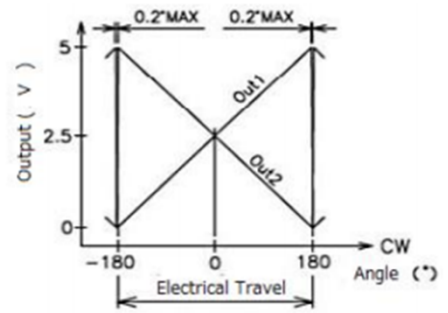

CP-45HP-5V Parallel Output

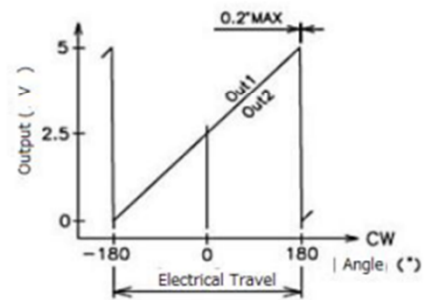

CP-45HP(180°Phase Output)

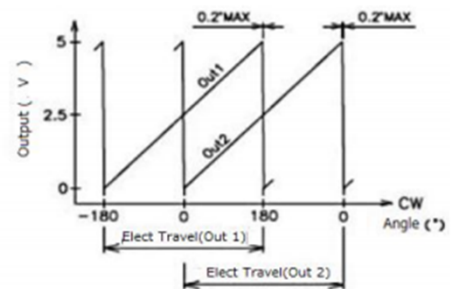

Dual Output, 4wires

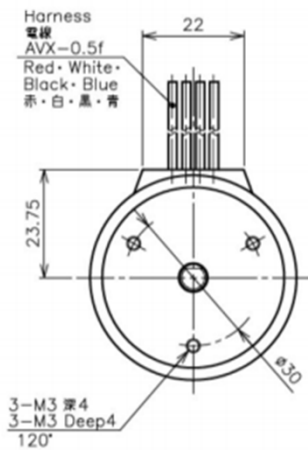

Dual Output, 4wires

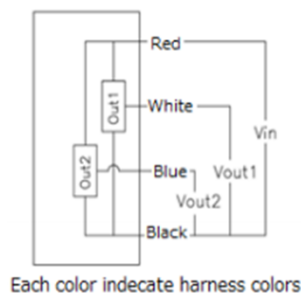

■ CP-45Hx-5V Model Number Designation

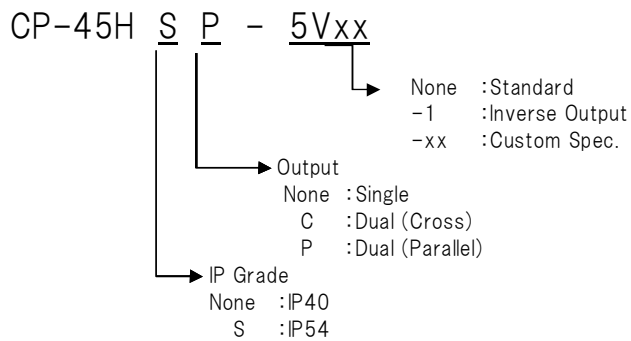

【Electrical Specifications】

Model No.	CP-45H-5V	CP-45HS-5V	CP-45HC-5V	CP-45SC-5V	CP-45HP-5V	CP-45HSP-5V	
Effective Electrical Travel	360						°
Output Range	0~5						V
Absolute Linearity	±1.0						%FS
Input Voltage	DC8~32						V
Load Resistance	10						kΩ
Supply Current	13						mA/1ch
Insulation Resistance	100 MIN /DC50						MΩ
Output Resolution	12(0~100%Vin) (Shaft Rotational Speed 16rpm MAX.)						bit
Response Time	0.9						ms
Hysteresis	±0.2 MAX.						%FS
Temp. Characteristics -40~100°C(Ref.Temp.25°C)	±3.6 MAX.						°
Dual Output Difference	---	100±1.5 (Sum 1,2)			±1.5		%Vin

【Mechanical Specifications】

Model No.	CP-45H-5V	CP-45HS-5V	CP-45HC-5V	CP-45SC-5V	CP-45HP-5V	CP-45HSP-5V	
Total Mechanical Travel	360 Endless						°
Torque	1.8	30	1.8	30	1.8	30	mN·m
Thrust Load Tolerance	2						N
Radial Load Tolerance	6						N
Mass	Approx. 100						g

【Environmental Specifications】

Model No.	CP-45H-5V	CP-45HS-5V	CP-45HC-5V	CP-45SC-5V	CP-45HP-5V	CP-45HSP-5V	
Life Cycles	10M (Room Temp. , No Load, CW/ CCW)						Cycle
Category Temp. Range	-40~+100 (No condensation)						°C
Storage Temp. Range	-40~+100 (No condensation)						°C
Vibration	5~500Hz(6min) 200m/s ² (20G) 3directions 4hours each						
Shock	1000m/s ² (100G) 6directions 3times						
E M S	100V/m 1M~1GHz (ISO 11452)						
ESD (Case to Each Terminal)	±15MAX. (IEC 61000-4-2)						kV
ESD (Between Each Terminal)	±15MAX. (IEC 61000-4-2)						kV
IP Level	IP40	IP54	IP40	IP54	IP40	IP54	

■ Handling Instruction

- This product may be influenced from external magnetic field.
- Use this sensor in the place where is protected from ESD.