



MAGNETS

PM5 Series – Compatible Magnet for PS501 Series

PM50

Design Features

- ◆ High quality Magnet selected

Product Comments

- ◆ Robust Nylon 6.6 housing
- ◆ Magnet selected to work with PS5 Series

Typical Applications

- ◆ Door Interlocks
- ◆ Hook Switches
- ◆ Security Systems
- ◆ Safety Interlocks
- ◆ Position Indication

Material, Design and Operation

| | |
|---------------------------|------------------------|
| Mounting | Cylindrical |
| Material | 30% Glass Filled Nylon |
| Housing Temperature Range | 130°C |
| Housing Material | Plastic |
| Operating Temperature °C | 70 |
| Operate Distance | 4mm |
| Operate Direction | Front |
| Magnetic Approach | End Operate |

PM50

PM5 Series – Compatible Magnet for PS501 Series

Line Drawing

PM50

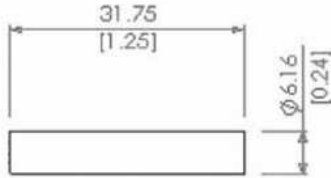

PS501 & PM50

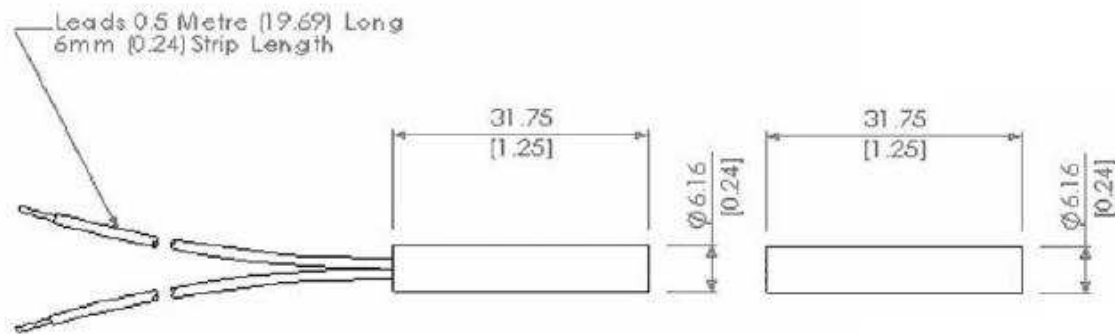

NORTH AMERICA & EUROPE

TE Connectivity
Hauert 13
D-44227 Dortmund
Germany
Phone: +49-(0)231-9740-0
Fax: +49-(0)231-9740-20
customer@te.com

ASIA

TE Connectivity
No. 26 Langshan Road
Shenzhen High-Tech Park (North)
Nanshan District, Shenzhen 518057 China
Tel +86 755 3330 5088
Fax +86 755 3330 5099

te.com

TE Connectivity, TE Connectivity (logo) and Every Connection Counts are trademarks. All other logos, products and/or company names referred to herein might be trademarks of their respective owners.

The information given herein, including drawings, illustrations and schematics which are intended for illustration purposes only, is believed to be reliable. However, TE Connectivity makes no warranties as to its accuracy or completeness and disclaims any liability in connection with its use. TE Connectivity's obligations shall only be as set forth in TE Connectivity's Standard Terms and Conditions of Sale for this product and in no case will TE Connectivity be liable for any incidental, indirect or consequential damages arising out of the sale, resale, use or misuse of the product. Users of TE Connectivity products should make their own evaluation to determine the suitability of each such product for the specific application.

© 2017 TE Connectivity Ltd. family of companies All Rights Reserved.

